

1000 WOG 3-PIECE FULL BORE

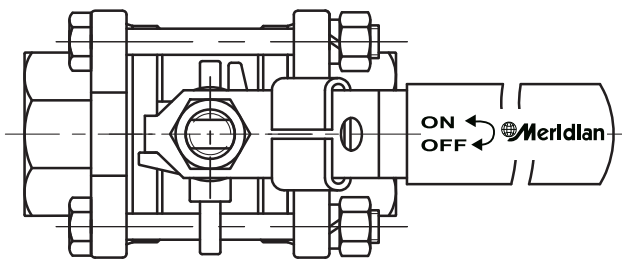
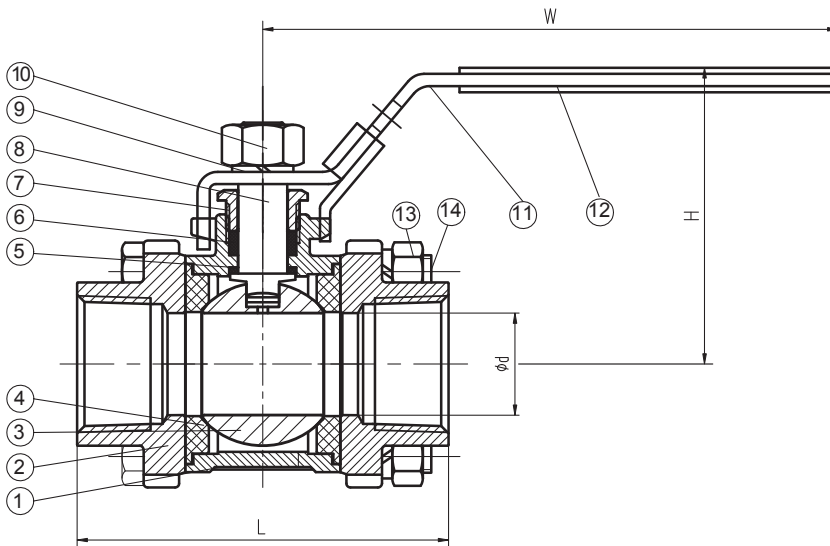

DIMENSIONS

DN	ϕd	L	B	H	W	Weight KG	Cv
8	11.6	68.5	34.25	54	98	0.4	6
10	12.5	68.5	34.25	54	98	0.4	7
15	15	73	36.5	58.5	105	0.6	10
20	20	84	42	65.5	120	0.86	25
25	25	90.5	45.25	74	150	1.12	35
32	32	112	56	90	160	1.89	46
40	38	120	60	96	180	2.45	80
50	50	148	73.4	104	180	3.89	110
65	65	180	90	122	250	8.51	310
80	80	205	102.5	128	250	13.73	360

NPS	ϕd	L	B	H	W	Weight LB	Cv
1/4"	0.46	2.7	1.35	2.13	3.86	0.88	6
3/8"	0.49	2.7	1.35	2.13	3.86	0.88	7
1/2"	0.59	2.87	1.44	2.3	4.13	1.32	10
3/4"	0.78	3.31	1.65	2.58	4.72	1.90	25
1"	0.98	3.56	1.78	2.91	5.95	2.47	35
1-1/4"	1.26	4.41	2.2	3.54	6.3	4.17	46
1-1/2"	1.50	4.72	2.36	3.78	7.09	5.40	80
2"	1.97	5.83	2.89	4.09	7.09	8.58	110
2-1/2"	2.56	7.09	3.51	4.8	9.84	18.76	310
3"	3.15	8.07	4.03	5.03	9.84	30.27	360

FEATURES

- Threaded ends conform to ASME B1.20.1 (NPT)
- Investment casting
- Blow-out proof stem
- Full bore
- 1000 psi
- Carbon filled PTFE seats
- Latch lock handle
- Socket weld ends optional
- Pressure tested to API 598

ITEM	PARTS	MATERIAL
01	BODY	ASTM/A351/CF8M
02	CAP	ASTM/A351/CF8M
03	BALL	ASTM/A182/F316
04	SEAT	RPTFE
05	THRUST WASHER	PTFE
06	PACKING	PTFE
07	GLAND BUSH	ASTM/A276/304
08	STEM	ASTM/A276/316
09	WASHER	AISI 201
10	NUT	AISI 304
11	HANDLE	SS
12	HANDLE COVER	PVC
13	NUT	AISI 304
14	BOLT	AISI 304

